



# Lodge Facts & Rates



## Location

Clayoquot Wilderness Lodge sits amongst the lush coastal rainforest of remote Vancouver Island in British Columbia, Canada. Surrounded by the UNESCO listed Clayoquot Sound Biosphere, and flanking the pristine Strathcona Provincial Park, the 600 acre property sits at the head of the Bedwell River making it an ideal location to explore the wilds of the Island. Inaccessible by car, the lodge is reached by a 45 minute seaplane flight from Vancouver, or 35 minute boat ride from Tofino.

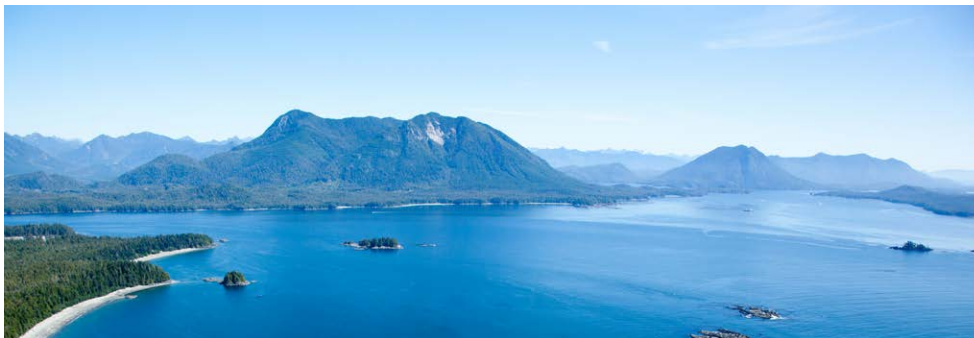

## Climate

The temperate rainforests that dominate the landscape and ecosystem at Clayoquot Sound also drive the weather systems. While the region generally receives rain that sustains its forests, in summertime the conditions are warm and quite dry, ideal for marine sports and outdoor activities and making summer and shoulder months an ideal time to visit.

Season	Average daytime temp	Average overnight temp
Summer (June-August)	15-19°C (59-66°F)	11-13°C (52-55°F)
Fall (September-November)	13-17°C (55-62°F)	6-10°C (43-50°F)
Winter (December-February)	5-8°C (41-46°F)	2-4°C (36-39°F)
Spring (March-May)	9-14°C (48-57°F)	5-10°C (41-50°F)

### Getting there

The easiest and quickest way to travel to Clayoquot Wilderness Lodge is to fly to Vancouver, British Columbia and connect with a scenic 45-minute seaplane flight directly to the resort dock on Clayoquot Sound. Boat and helicopter transfers are also available options.

[More details »](#)



### What to bring

Reflecting the adventurous nature of the Pacific Northwest wilderness, dress is relaxed at Clayoquot Wilderness Lodge. Solid walking shoes, comfortable clothes, layers for warmth, and a rain jacket are recommended. A hat and sunscreen are every day essentials.



# Stay

## Accommodation

Twenty-five luxuriously appointed white canvas tents in the style of turn-of-the-century prospectors, line the banks of the magnificent Clayoquot Sound and are dotted among the region's pristine old growth temperate rainforest. A Baillie Lodges-led reimagining of the tents' interiors brings a fresh new contemporary look to the accommodations with signature clean lines, generous appointments and pared back, refined luxury. End-of-the-bed views and specially commissioned furnishings from local designers evoke a personal connection with the Vancouver Island landscape.

### Rainforest Deluxe Tent

Rainforest Deluxe tents are enveloped in the cool reserves of old and new growth forest and feature generous king beds dressed in fine cloth linens and a signature Baillie Lodges Bemboka blanket plus double convertible sofa bed. A separate private bathroom is located just steps outside the tent and includes a shower and luxurious heated floors. Each tent features desk space, a cast iron heated stove, and opens to a verandah with traditional Adirondack chairs made for relaxing with a book and drinking in the view.



### Waterfront Deluxe Tent

Clayoquot's Waterfront Deluxe tents line the banks of the sound and offer sweeping views of the ocean and Bedwell River. The tents welcome in the rising sun each morning and feature private decks. The Waterfront Deluxe tents include a luxurious king bed that can be split into two king single beds and a double sofa bed. Flexible bedding options make this a popular choice for the in-laws or as a children's tent on family holiday stays. A private bathroom, located separately just steps outside the tent features a shower and luxurious heated floors.



#### Check-in / Check-out

Check-in and check-out days are on Sundays and Thursdays only. Check-in time is 3.30pm. Check-out time is 12 pm. Early check-in and late check-out are subject to availability - surcharge may apply. Guests arriving or departing outside standard check-in or check-out times are welcome to enjoy the lodge facilities.

#### N° of tents

4

#### Size

30m<sup>2</sup> (323 ft<sup>2</sup>)

#### Capacity

4 guests in existing bedding

#### N° of tents

1

#### Size

30m<sup>2</sup> (323 ft<sup>2</sup>)

#### Capacity

4 guests in existing bedding



## Rainforest Ensuite Tent

Rainforest Ensuite tents are set amongst Clayoquot's magnificent temperate rainforest and feature a luxurious king bed with fine linens and signature Baillie Lodges Bemboka blanket. A desk and wardrobe adjoin a convertible double sofa bed. The tent's ensuite bathroom features heated floors, double sinks and a private outdoor cedar shower with views up into the lush green rainforest canopy. Each tent features desk space, a cast iron heated stove and bespoke local design pieces. An outdoor verandah overlooks the rainforest with Clayoquot Sound beyond.

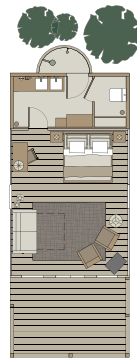

---

N° of tents

3

Size

63m<sup>2</sup> (678 ft<sup>2</sup>)

Capacity

4 guests in existing bedding

## Waterfront Ensuite Tent

Waterfront Ensuite tents are located on both sides of the Bedwell Bridge and line the banks of Clayoquot Sound offering direct views to the water and its boisterous wildlife. These tents either face the rising sun or are situated on the secluded side of the Bedwell River, alongside the rainforest. These tents promise generous king bed comfort with fine linens and the signature Bemboka blanket plus a double sofa bed and an outdoor deck with traditional Adirondack seating. An in-tent ensuite bathroom features heated floors, double vanity and a private outdoor cedar-clad shower. Each tent features desk space, a cast iron heated stove and comfortable, contemporary furnishings.

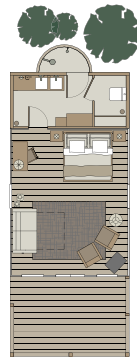

---

N° of tents

16

Size

38.5m<sup>2</sup> (414 ft<sup>2</sup>)

Capacity

4 guests in existing bedding

## Hillside Family Tent

The generously spacious Hillside Family Tent is made up of two adjoining tents and is set high on the hillside among the lush old and new growth rainforest with views of Clayoquot Sound. The two-bedroom, two-bathroom Hillside Family Tent is ideal for families or friends travelling together. The master bedroom features a king bed and lounge area with double sofa bed while the second bedroom offers two twin beds (converting to king bed as required) and a double sofa bed. Adjoining each bedroom is an ensuite bathroom with heated floors, double vanity and private outdoor cedar-clad shower, while a deep bathtub is ideal for a post-hike soak. Outside, a private outdoor deck is perfect for relaxing among the sights and sounds of the rainforest.

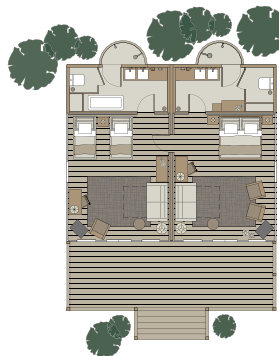

---

N° of tents

1

Size

154.5m<sup>2</sup> (1,663 ft<sup>2</sup>)

Capacity

4 adults and 4 children in existing bedding



# Lodge



## The Cookhouse

Located on the foreshore of Clayoquot Sound and welcoming magnificent views of its vast oceanic wilderness, The Cookhouse is the hub of dining, drinking and lounging. The main restaurant features an open kitchen promising entertaining coal-face style theatre and a daily-changing menu of locally sourced sustainable produce. Generous lounging flows to the decks outside, a perfect spot to relax and drink in the views. In the evenings a fire draws in guests for s'mores and shared stories. Adjacent canvas tents welcome special occasion or private dining, live music events and a friendly game of billiards.

### What's included

- All gourmet dining
- A selection of premium wines, beers and spirits, non alcoholic beverages
- Signature guided experiences
- One 60-minute relaxation massage per person

## The Ivanhoe Lounge

Named for Clayoquot's vintage 110-foot landing craft boat, the SS Ivanhoe, the Ivanhoe rests at the very edge of the estuary where the Bedwell River spills into the Pacific Ocean. Located adjacent to the restaurant, The Ivanhoe is a dedicated bar and lounge with floor-to-ceiling glass welcoming in views of the sound with one of the world's most diverse natural environments sees bears, eagles, blue herons, otters, and seals go about their business on the foreshore. Inside, guests lounge with handcrafted cocktails in generous leather armchairs and on swarthy lounges warmed by a cast iron stove. A menu of canapés and bar snacks complements premium wines, craft beers and small-batch spirits.

## Healing Grounds Spa

The Healing Grounds Spa features two indoor treatment rooms, a waterfront tent, wood-fired sauna and a series of relaxing hot tubs set in the decks, looking out to the sound and surrounding coastal forest. A yoga studio offers daily morning classes along with guided meditation sessions. Morning forest bathing in the nearby old and new growth rainforest and healing sound therapy sessions are popular new offerings from the spa.

### Additional charges apply

Browse the range of Healing Grounds Spa treatments and submit your booking online, view a printable menu or contact a reservations agent on 1 250 266 0397.

## The Outpost

The resort's hub for dining, lounging and recreation, The Outpost is centrally located near the Bedwell Bridge and broadly comprises The Cookhouse and adjoining dining and social gathering tents, the pick-up point for water sports equipment including kayaks and canoes and the meeting point for guided tours. A state-of-the-art fitness centre is free for guest use and includes a full suite of exercise and mobility equipment, while nearby a twenty-metre treeclimb to a forest canopy viewing platform offers panoramic vistas across Clayoquot Sound.





# Experience



## Signature experiences

Located at the heart of Vancouver Island's wild-west playground, Clayoquot Wilderness Lodge sits in the pristine UNESCO-designated Clayoquot Sound Biosphere Reserve. The lodge offers a series of extraordinary nature-based adventures and a personalized itinerary is created for each guest and presented on arrival. Guests have direct access to 600-acres of gloriously wild nature reserve and opportunities abound for adventure, education, natural enrichment and personal connection. Experiences span equestrian, marine-based and land-based and are led by personal guides. These activities are provided on an intimate shared basis with fellow guests at scheduled times.

**Signature experiences:** Canyoning, Hiking, Horseback Riding, Sights of the Sound tour or Walk the Wildside tour (subject to length of stay) and Watersports.

### What's included

Signature experiences are included in all rates. View more details on our website.

## À la carte experiences

An additional menu of à la carte experiences is offered to tailor an even more personalized itinerary of Clayoquot excursions. From archery to rock climbing or biking the Bedwell, there's something for everyone. These optional guided activities are shared with fellow guests at scheduled times.

**À la carte experiences:** Archery, Catch & Release Fishing, Disc Golf, Mountain Biking, Rock Climbing and The Tree Climb.

### What's included

À la carte experiences are included in all rates. View more details on our website.

## Bespoke heli experiences

To make a stay at Clayoquot Sound truly unforgettable, we also offer a menu of bespoke helicopter experiences designed to suit every interest and occasion. The decadent 90-minute Sip to Sky flight is a popular option, taking in the natural highlights of the reserve whilst enjoying sky-high signature drinks and canapés.

**Bespoke heli experiences:** Design-your-own Heli Adventure, Heli Fly Fishing, Heli Hiking and Sip to Sky scenic flight.

### Additional charges apply

Helicopter tours are privately guided. For more information visit the lodge website, additional charges apply.



# Getting there



## Access

The easiest and quickest way to travel to Clayoquot Wilderness Lodge is to fly to Vancouver, British Columbia (YVR) and connecting with a scenic 45-minute seaplane flight directly to the resort dock on Clayoquot Sound. Boat and helicopter transfers are also available options.

Seaplane and boat transfers to and from Vancouver International Airport are not included in the tariff, however, Clayoquot Reservations can assist with all arrangements and add these services to your reservation to create a seamless total package.

## Seaplane

Arrival by scenic seaplane flight is the most popular, convenient and generally spectacular means of transport to and from Clayoquot Wilderness Lodge.

Clayoquot works with Richmond Seair Seaplanes as preferred operator, which offers service on 5, 7 or 9-seater single engine planes departing Vancouver Airport's South River Terminal at regular scheduled times. Guests are advised to land at Vancouver Airport by 12 noon for the 15-minute transfer to the terminal.

Guests may opt for private transfers to meet private charter seaplane flights to Tofino or direct to the resort dock. The recommended baggage limit is 40lb (18 kilograms) per person.

Seaplane transfers cost CAD \$625 per person, each way.

## Boat

Guests can also boat in on Clayoquot's own 12-seater vessel, The Norwester for the 35-minute passage from Tofino. Complimentary car parking is available and coordinated by our reservations team who arrange a valet service at the Tofino Resort and Marina. Boat transfers cost CAD \$300 each way per group of up to seven guests.

## Helicopter

Guests have access to the helipad for privately arranged helicopter arrivals and departures. However, please note this is not a service we provide and ambitions must be communicated with us in advance.

## Arrival and Departure Locations

For detailed information on arrival and departure locations for seaplane and boat transfers, please visit the lodge [website](#).



# Rates



Valid June 17, 2021 - September 30, 2021

All rates quoted in Canadian Dollars; additional charges and taxes not included.

Rates as quoted are per person per night and include luxury tented accommodation, all gourmet dining, a premium selection of wines, beers and spirits, non alcoholic beverages, guided experiences, plus one 60-minute relaxation massage per stay (adults and youths only).

**Length of stay:** Clayoquot Wilderness Lodge offers packages based on a three night stay arriving Thursday and departing Sunday, a four night stay arriving Sunday and departing Thursday, or seven-night stays arriving either Thursday or Sunday.

## Peak season

Peak season rates are valid June 17 to September 8, 2021

Suite	Adult Rate	Youth Rate (13-18)	Child Rate (6-12)
Rainforest Deluxe Tent	\$1,700	\$1,275,	\$850
Waterfront Deluxe Tent	\$2,000	\$1,500	\$1,000
Rainforest Ensuite Tent	\$2,200	\$1,650	\$1,100
Waterfront Ensuite Tent	\$2,400	\$1,800	\$1,200
Hillside Family Tent	\$2,200	\$1,650	\$1,100

## Shoulder season

Shoulder season rates are valid September 9-30, 2021

Suite	Adult Rate	Youth Rate (13-18)	Child Rate (6-12)
Rainforest Deluxe Tent	\$1,400	\$1,050	\$700
Waterfront Deluxe Tent	\$1,500	\$1,150	\$750
Rainforest Ensuite Tent	\$1,700	\$1,275	\$850
Waterfront Ensuite Tent	\$1,800	\$1,350	\$900
Hillside Family Tent	\$1,700	\$1,275	\$850
Single Supplement	\$650	N/A	N/A

### Please note

- Scheduled seaplanes operate on set departures from Vancouver International Airport (South River Terminal) on Thursdays and Sundays.
- Single Supplement Rate applies to tents occupied by one adult.
- Youth and child rates apply when staying in the same tent as an adult; extra tents will be charged at a minimum rate of two adults.
- Minimum two adult rates per tent applies in peak season.
- A minimum of two adult and two children rate applies to the Hillside Family Tent in Shoulder season; the minimum rate in Peak season is equal to two adult and two youth.
- Clayoquot Wilderness Lodge welcomes children six years and over.



# Packages

Valid June 17, 2021 - September 30, 2021

All rates quoted in Canadian Dollars; additional charges and taxes not included.



## Clayoquot Classic

**Experience the wonder of Vancouver Island over seven nights, pay only six.**

A seven-night stay offers guests the chance to really discover the extraordinary wilderness of Clayoquot Sound, taking time out to encounter bears and whales in the wild, take a kayak or canoeing adventure, explore the heights by helicopter or venture out on horseback. After all the action, unwind with an additional 60-minute massage in the Healing Grounds Spa.

Peak or shoulder season rates apply, depending on travel dates.

- Valid June 17, 2021 to September 30, 2021.
- Single supplement rates available
- Minimum two adult rates per tent applies in peak season. Youth and child rates apply when staying in the same tent as an adult; extra tents will be charged at a minimum rate of two adults.

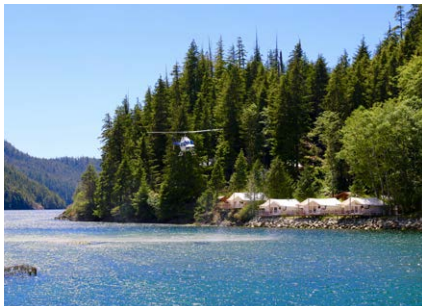

## Clayoquot Classic Platinum

**Stay for ten unforgettable nights including one complimentary night plus a swag of extras.**

Settle in for a long-stay and feel at home over ten nights (and pay for only nine). In addition to Clayoquot Classic inclusions, explore the region from the air with a credit of \$1,000 per tent towards a scenic flight of choice. One evening during the stay, savour a Quadra Chef's private degustation dinner per tent featuring premium local produce and fine matched wines.

Peak or shoulder season rates apply, depending on travel dates.

- Valid June 17, 2021 to September 30, 2021.
- Single supplement rates available
- Minimum two adult rates per tent applies in peak season. Youth and child rates apply when staying in the same tent as an adult; extra tents will be charged at a minimum rate of two adults.

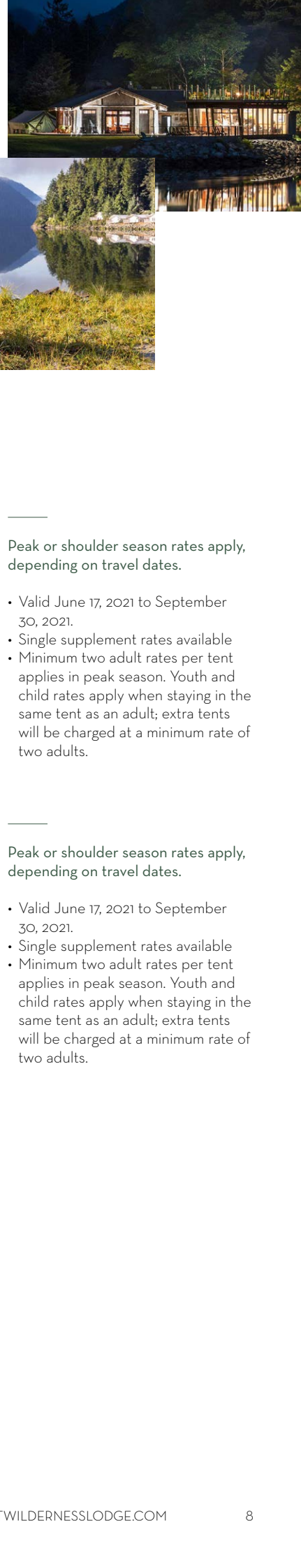





# Policies

---

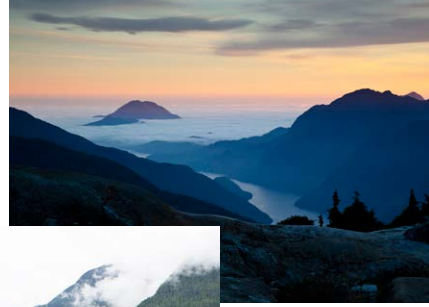

## Payment, deposit & cancellation policy

A credit card is required to confirm a reservation. A 50% deposit is required at time of booking. All bookings require full prepayment 90 days prior to arrival. We accept Visa, MasterCard or American Express. Settlement is also accepted by direct deposit; please advise Clayoquot Reservations once paid to ensure receipt.

We do our best to accommodate guest requests under extraordinary circumstances, but due to our short season and remote location, we cannot make exceptions to our deposit and cancellation policies.

As such, for cancellations outside of 90 days from arrival, a \$500 per person cancellation fee is applied, with the remaining deposit refunded. Cancellations made within 90 days of arrival result in full forfeiture of the deposit paid.

Refunds may not be granted in the event of non-arrival, any unused services or unused nights due to flight or weather disruptions. We very strongly recommend for peace of mind all guests purchase travel insurance.

---

### Contact us

To speak with a Reservations Consultant, please call 1 250 266 0397 during business operation hours: Monday-Friday 9am-5pm PST.

## Service charge, taxes & fees

In lieu of tipping, please note a 14% Service Charge is applied to the pre-tax total bill for the benefit of all our resort staff. A Resort Fee of 3% applies to all reservations. Federal GST is added at 5%.

## Child policy

Clayoquot Wilderness Lodge welcomes children aged six years and over. Child rates apply to guests aged 6-12 years, while youth rates apply to guests aged 13-18 years old.

## Environmental sustainability

Clayoquot Wilderness Lodge is dedicated to preserving the natural habitat of Clayoquot Sound which provides the setting for the magnificent experiences we offer. As such, an Environmental Sustainability surcharge of 3% is added to all bookings to help fund our leading local conservation efforts.

## COVID-19 travel disruption exception

In the event that your travel plans are disrupted due to circumstances arising from COVID-19 i.e. due to a positive test within your travelling party, a stay-home order issued by a local authority, or border closures preventing travel between your area and Clayoquot Wilderness Lodge, we will gladly amend your booking and hold any funds paid in credit upon verification of the circumstance. Should no suitable alternative stay be possible, a full refund will be issued.