



Lodge Facts & Rates



Location

Treasured as Australia's spiritual heart, the dual World Heritage-listed wilderness of Uluru-Kata Tjuta National Park is an ancient desert landscape widely known as the 'Red Centre'. Spanning a vast expanse of the Northern Territory, the outback's rugged beauty is heightened by the living presence of one of the world's largest monoliths, Uluru (Ayers Rock) and the sacred red domes of Kata Tjuta (The Olgas) which stand nearby. It's a land of stark contrasts, playing spiritual home to the world's oldest living culture, the indigenous Australians, whilst revealing a more modern history with the folklore of the early western explorers.

Getting there

Uluru-Kata Tjuta National Park is located in the Red Centre in Australia's Northern Territory. The main airport, Ayers Rock Airport is three hours' travel by air from most Australian capital cities. Longitude 131° is located 15 minutes' drive from Ayers Rock Airport via lodge transfer, a three hour self-drive from Kings Canyon and a five hour self-drive from Alice Springs. [More details »](#)

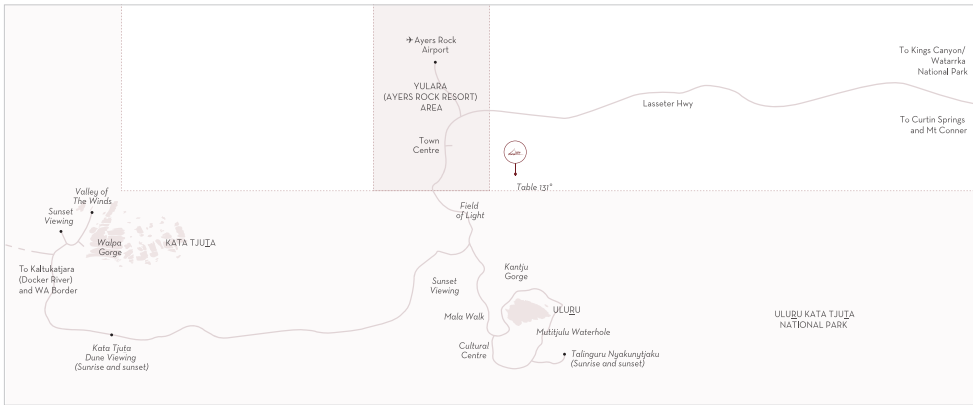

Climate

The semi-arid climate produces great travelling conditions. Warm, sunny days with minimal rainfall are the norm for much of the year. Typical desert weather patterns make for reasonable fluctuations in temperature between day and night. During the summer months, average temperatures range from 35°C during the day to 18°C overnight. In the winter months, the average daytime temperature is 22°C and 0°C overnight.

What to bring

Reflecting the easy-going nature of the outback, dress is relaxed at Longitude 131°. Humidity is low in the arid Red Centre; days are sunny and can be hot, with cooler nights that can become quite crisp and cold in winter. Solid walking shoes, comfortable casual clothes and some layers of warmer clothes if travelling in the cooler months are recommended. Hat and sunscreen are essential year round. A camera and keen sense of adventure are a must!

Season	Average daytime temp	Average overnight temp
Summer (December-February)	35-38°C	19-21°C
Autumn (March-May)	24-35°C	8-17°C
Winter (June-August)	20-24°C	0-6°C
Spring (September-November)	29-35°C	9-17°C



Stay



Accommodation

Nestled among rust-red dunes, Longitude 131° is a gathering of sixteen luxury tents. Unparalleled views of Uluru's changing lights play out from the end of the bed, or on balconies from the warmth of a swag unfurled in the cool night air. Custom furnishings invite stylish lounging, while works by local indigenous artists offer inspiration. All tents feature king beds, a generous bathroom and lounge opening to a private balcony with fireplace. Other features include climate control, complimentary in-suite bar, wireless internet, music system, premium amenities, safe and telephone. Bathrobes, slippers, hairdryer and backpacks are provided along with daily housekeeping and signature evening turndown service.

Check-in / Check-out

Check-in time is 2pm and check-out time is 10.30am. Where possible, flexibility with early check-in and late check-out will be provided, however, these are unable to be guaranteed.

Children

Longitude 131° welcomes children ten years and over.

Luxury Tent

Each retreat pays homage to an early Australian explorer or pioneer, contrasted with the colourful textures of local indigenous artworks. The bespoke 'Baillie Bed' takes centre stage beneath the soaring canopy, adjoined by an ensuite bathroom with rain-shower. An expansive balcony with day bed and feature fireplace offers another perspective for drinking in the view.

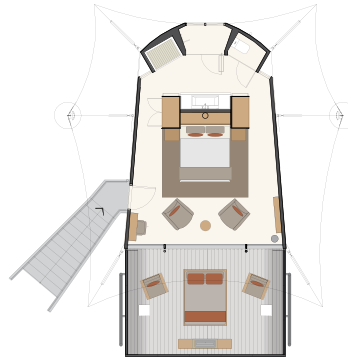

N° of tents

15

Size

63m²

Capacity

2 adults in existing bedding
Max capacity 3 persons with rollaway (limited availability)

Dune Pavilion

The Dune Pavilion is the only accommodation offering dual views of Uluru and Kata Tjuta. Designed as a contemporary Australian homestead, the pavilion features separate living and sleeping quarters and is appointed with custom furnishings, indigenous artworks and spacious ensuite bathrooms with an outback-style bathtub for soaking in the scenery. Generous outdoor decks offer the ultimate in desert glamour: decadent lounging, fireplace and a plunge pool overlooking the desert frontier. Configured as one or two bedrooms, it's ideal for couples seeking a sophisticated retreat or friends or families travelling together.



N° of tents

1

Size

153m²

Capacity

4 adults in existing bedding
Max capacity 5 persons with rollaway (limited availability).

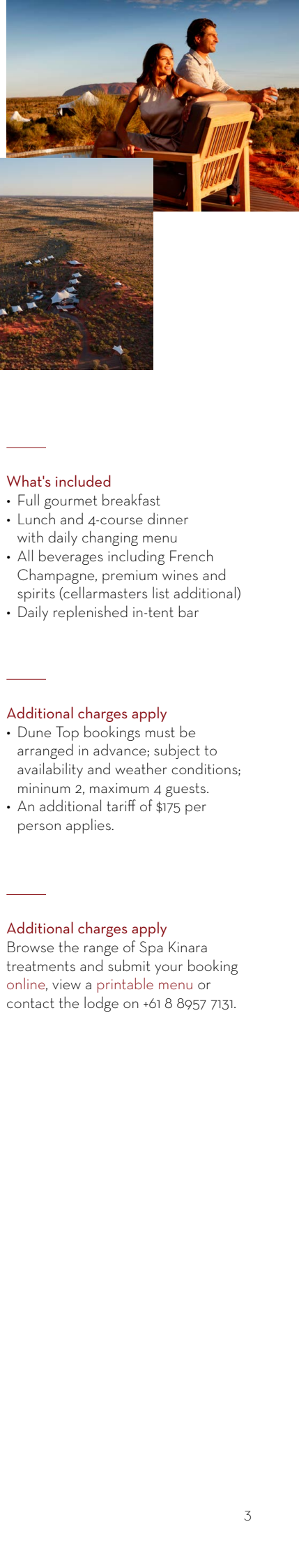

Lodge

The Dune House

The Dune House is the central hub of Longitude 131°, where guests dine and relax. The welcome open spaces include the restaurant with ever-changing views of the monolith as a backdrop for fine dining as well as lounging areas ideal for reclining with an icy drink. The feel-at-home bar is available throughout the day and the outdoor swimming pool with poolside bar invites a refreshing dip.

What's included

- Full gourmet breakfast
- Lunch and 4-course dinner with daily changing menu
- All beverages including French Champagne, premium wines and spirits (cellarmasters list additional)
- Daily replenished in-tent bar

The Dune Top

Positioned at the highest point at Longitude 131°, the Dune Top is surrounded by 360° panoramic views - it's the perfect venue to drink in the changing colours of Uluru and Kata-Tjuta. By day, survey the scene from the deck or from the cool of the plunge pool (or warmth in winter) and select an icy beverage from the bar - it's always a toast-worthy moment! By night, the Dune Top transforms into a sleek setting for sundowners. Secluded dining alcoves offer the option to dine intimately under the stars.

Additional charges apply

- Dune Top bookings must be arranged in advance; subject to availability and weather conditions; minimum 2, maximum 4 guests.
- An additional tariff of \$175 per person applies.

Spa Kinara

A cool sanctuary in Australia's rich red desert, Spa Kinara sits low in the sand dunes at Longitude 131°, connecting the sky to the earth and offering travellers a welcome retreat. A signature menu of treatments features the Australian made Li'Tya spa care range complemented with Central Australia's surprising resource of native beauty products. Two standalone retreats inspired by the design of a traditional indigenous shelter offer guests a sense of true calm and of being grounded in the landscape.

Additional charges apply

Browse the range of Spa Kinara treatments and submit your booking [online](#), view a [printable menu](#) or contact the lodge on +61 8 8957 7131.

Services

Reception and boutique, wireless internet, television in communal lounge, daily laundry and dry cleaning service (charges apply), postal service, doctor on call. All major credit cards are accepted at Longitude 131°.

Luxury Lodges of Australia

Longitude 131° is honoured as a founding member of Luxury Lodges of Australia, celebrating a new era of Australian experiential luxury accommodation and adventure.



Experience

Signature experiences

With Longitude 131° as luxury basecamp, guests can explore the protected cultural and natural landscape of Uluru-Kata Tjuṯa National Park. The Lodge offers an exceptional complimentary touring program, allowing a personal encounter with the region's iconic natural attractions. Experiences are provided on an intimate shared basis with fellow guests at scheduled times. Times are seasonal and subject to sunrise and sunset which vary throughout the year, weather permitting. Touring rotates on a daily basis and all guests enjoy a personalised experiential touring itinerary, with activities scheduled depending on the time and day of arrival.

Signature experiences: Uluru Sunset, Field of Light, Table 131°, Walpa Gorge & Kata Tjuṯa, Mala Walk & Kantju Gorge, Mutitjulu Meander.

What's included

Signature experiences are included in all rates. View more details on our [website](#).

Bespoke experiences

An additional menu of Uluru-Kata Tjuṯa National Park experiences and beyond offers the chance to tailor a special interest itinerary. An amazing helicopter flight over Uluru or Kata Tjuṯa is the only way to fully appreciate the scale and grandeur of this spectacular region. Take an exhilarating Harley Davidson motorcycle tour around the base of Uluru or meander through the red sand dunes atop a camel to watch the awe inspiring backdrop of Uluru and Kata Tjuṯa change colour as the sun rises or sets. Activities operate on a limited share basis and charges apply.

Additional charges apply

Bespoke experiences are privately guided and additional charges apply. View more details on our [website](#).

Private experiences

Many guests value the option of private touring, ensuring an experience of Uluru-Kata Tjuṯa in the exclusive company of immediate fellow travellers, be they family and or friends. Guests on private tours have the luxury of touring at their own pace, and may follow an itinerary of private signature experiences or tailor their own. Transport is in a luxury private vehicle with a personal lodge guide. Advance bookings are essential, charges apply.

Additional charges apply

The tariff commences from AUD \$3,000 for four guests, while larger vehicle options are available for groups of up to 16 passengers. Subject to availability, advance booking is essential.

Other activities

The Red Centre offers a swag of options for guests looking to explore more or perhaps pursue a special interest. Longitude 131° works with select local operators to offer these special adventures.

Additional charges apply

View more details about other activities on our [website](#).

Language guides can be arranged to accompany guests on scheduled touring (seat in coach) and in addition to Private Touring. Arranged at an additional cost and subject to availability.



Getting there



Access

Uluru-Kata Tjuta National Park is located in the Red Centre in Australia's Northern Territory. The main airport, Ayers Rock Airport is three hours' travel by air from most Australian capital cities. Longitude 131° is located 15 minutes' drive from Ayers Rock Airport via lodge transfer, a three hour self-drive from Kings Canyon and a five hour self-drive from Alice Springs.

Commercial flights

Commercial flights are available to Ayers Rock Airport (AYQ) for Uluru. Two airlines provide connecting flights from most major domestic destinations.

Jetstar (Qantas code share) flies directly to AYQ daily from Sydney; flights from Melbourne and Brisbane operate on selected days.

Qantas operates daily flights to AYQ via Alice Springs (ASP) from Sydney and Melbourne. Qantas flights from Brisbane operate on selected days. Qantas also offers daily direct flights to AYQ from Cairns. Flights from Adelaide and Darwin operate twice weekly on selected days.

Charter flights

Charter flights are available to Kings Canyon and Alice Springs and other regional ports by special arrangement.

Self drive

Self-driving to Uluru is another option with many itineraries travelling via Kings Canyon some 325 kilometre or 3.5 hours' drive to the north located and Alice Springs located 445 kilometres north-west of Yulara (approximately 4.5 hours' drive). All major national car rental companies operate from Alice Springs. Hire cars are also available from Ayers Rock Airport for guests planning a road trip following a stay at Longitude 131°.

Airport transfers

The lodge operates airport transfers for guests, which are included in the tariff and connect with scheduled flights to and from Ayers Rock Airport.

Private airport transfers

Private transfers between Longitude 131° and Ayers Rock Airport may be arranged subject to availability for an additional charge.

What's included

The lodge operates complimentary airport transfers connecting with scheduled flights to and from Ayers Rock Airport shared with fellow guests.

Additional charges apply

Private transfers can be arranged for an additional tariff of \$200 for up to four passengers (additional passengers \$50 per person) each way.

Additional charges apply

Charter flights require reservation in advance and incur additional charges.

Please note

Private vehicle access isn't permitted at the property and parking is available at nearby Ayers Rock Resort. Longitude 131° provides complimentary return transfers and prior arrangements are required.



Rates



Valid 1 April 2021 - 31 March 2022

All rates quoted in Australian Dollars and inclusive of 10% GST

Nightly Rates

Rates as quoted are per person per night and include all dining, open bar[^] with French Champagne, premium wines and spirits, in-tent bar, signature experiences and return Ayers Rock Airport transfers.

Suite	Twin Share	Single
Luxury Tent	\$1,700	\$3,000
Dune Pavilion	\$3,400	\$6,400
Extra Person Rate	\$800	N/A

Holiday Season Surcharge of \$400 per person per night applies to guests staying 18 December 2021 - 7 January 2022 inclusive. *Luxury Tent*: Applies to first two guests. *Dune Pavilion*: Applies to first four guests.

Please note

- Minimum two night stay applies to all bookings
- No arrivals or departures are permitted on Christmas Day
- Extra Person Rate applies when staying in same luxury tent with a minimum of two persons
- Longitude 131° welcomes children ten years and over
- [^]Cellarmasters list available at additional cost

Classic Uluru Rates

Stay three nights or more and enjoy significant savings and an essential experience of Uluru-Kata Tjuta. Rates are per person and feature generous standard inclusions and signature excursions, plus the option to undertake a guided Uluru Base Walk. Two \$50 Spa Kinara credits^o invite relaxation and connection with the ancient surrounds. Bonus value up to \$2,440 per couple.*

Per person per:	3 nights Twin Share	Extra night Twin Share	3 nights Single	Extra night Single
Luxury Tent	\$4,590	\$1,530	\$8,100	\$2,700
Dune Pavilion	\$9,180	\$3,060	\$17,280	\$5,760
Extra Person Rate	\$2,400	\$800	N/A	N/A

Holiday Season Surcharge of \$400 per person per night applies to guests staying 18 December 2021 - 7 January 2022 inclusive. *Luxury Tent*: Applies to first two guests. *Dune Pavilion*: Applies to first four guests.

Please note

- Classic Uluru Rates are not combinable with other packages.
- ^oMaximum value per suite; credits may not be combined and must be applied to individual treatments
- ^{*}Bonus value based on two persons in the Dune Pavilion and complimentary package inclusions



Packages

Valid 1 April 2021 - 31 March 2022

All rates quoted in Australian Dollars and inclusive of 10% GST



Classic Uluru

Experience the wonder of the Red Centre over three nights from \$4,590pp twin share.

Ideal for a longer stay, Classic Uluru rates combine savings on Nightly Rates and the option to undertake a guided Uluru Base Walk, a must-do for keen walkers to the region. Two \$50 Spa Kinara credits* offer a chance to unwind and relax. Bonus value up to \$2,440 per couple.

Per person twin share

Suite	AUD
Luxury Tent	\$4,590
Dune Pavilion	\$9,180

- Single / Extra Person rates available
- Classic Uluru Rates may not be combined with other packages
- Bonus value based on two persons in the Dune Pavilion and complimentary package inclusions
- *Maximum value per suite; credits may not be combined and must be applied to individual treatments
- A holiday Season Surcharge of \$400 per person per night applies to guests staying 18 December 2021 - 7 January 2022 inclusive. Luxury Tent: Applies to first two guests. Dune Pavilion: Applies to first four guests.



Classic Platinum

Reserve four nights or more on Classic Uluru Rates from \$6,120pp twin share.

In addition to Classic Uluru inclusions, explore Australia's heartland from the air with a credit of \$250 per tent towards a scenic flight of choice and savour a night's dining on the Dune Top beneath a blanket of stars. Bonus value up to \$3,720 per couple.

Per person twin share

Suite	AUD
Luxury Tent	\$6,120
Dune Pavilion	\$12,240

- Single / Extra Person rates available
- Bonus value based on two persons in the Dune Pavilion and complimentary package inclusions
- Classic Rates may not be combined with other packages
- A holiday Season Surcharge of \$400 per person per night applies to guests staying 18 December 2021 - 7 January 2022 inclusive. Luxury Tent: Applies to first two guests. Dune Pavilion: Applies to first four guests.



Policies

Payment & Cancellation Policy

Full prepayment is required two months prior to arrival. We accept Visa, MasterCard, American Express or direct deposit. Payment by Visa or MasterCard attracts a 1.6% surcharge; American Express payments attract a 2.475% surcharge (surcharges subject to change). Additional conditions apply to groups of five or more suites; package rates may not apply. As a small boutique property our business depends on maximising occupancy, cancellations often result in empty rooms due to booking lead times and limited air capacity. Cancellations within two months of arrival 50% of total paid will be refunded. Within one month prior to arrival all monies will be forfeited. No refund can be given in the event of non-arrival, any unused services or unused nights due to flight or weather disruption. We recommend that you protect yourself with travel insurance. Rates are subject to change without notice.

Contact us

To speak with a Reservations Consultant, please call +61 2 9918 4355 during business operation hours: Monday-Friday 8am-6pm and Saturday 8.30am-4.30pm (AEST).

Covid-19 Peace of Mind

Travel with confidence knowing full flexibility is offered for change of plans due to Covid-19 related health matters or domestic travel restrictions including cancellation, date change or refund for all stays up until 31 March 2022.

Peak Season Deposit Policy

All bookings over the Christmas/New Year period, 18 December 2021 to 7 January 2022 inclusive, must be secured with a non-refundable deposit of one night's accommodation within 14 days of reservation.

Child Policy

Longitude 131° welcomes children ten years and over.

Sustainability Policy

The Baillie Lodges environmental commitment is best expressed by each lodge's interaction with its local natural and cultural surroundings. A dynamic environmental management plan featuring cutting edge and continually evolving technologies steers lodge operations and ultimately enhances each guest's experience. [View our sustainability policy.](#)